

APPENDIX H

TIGER SALAMANDER GUIDANCE AND ANALYSIS

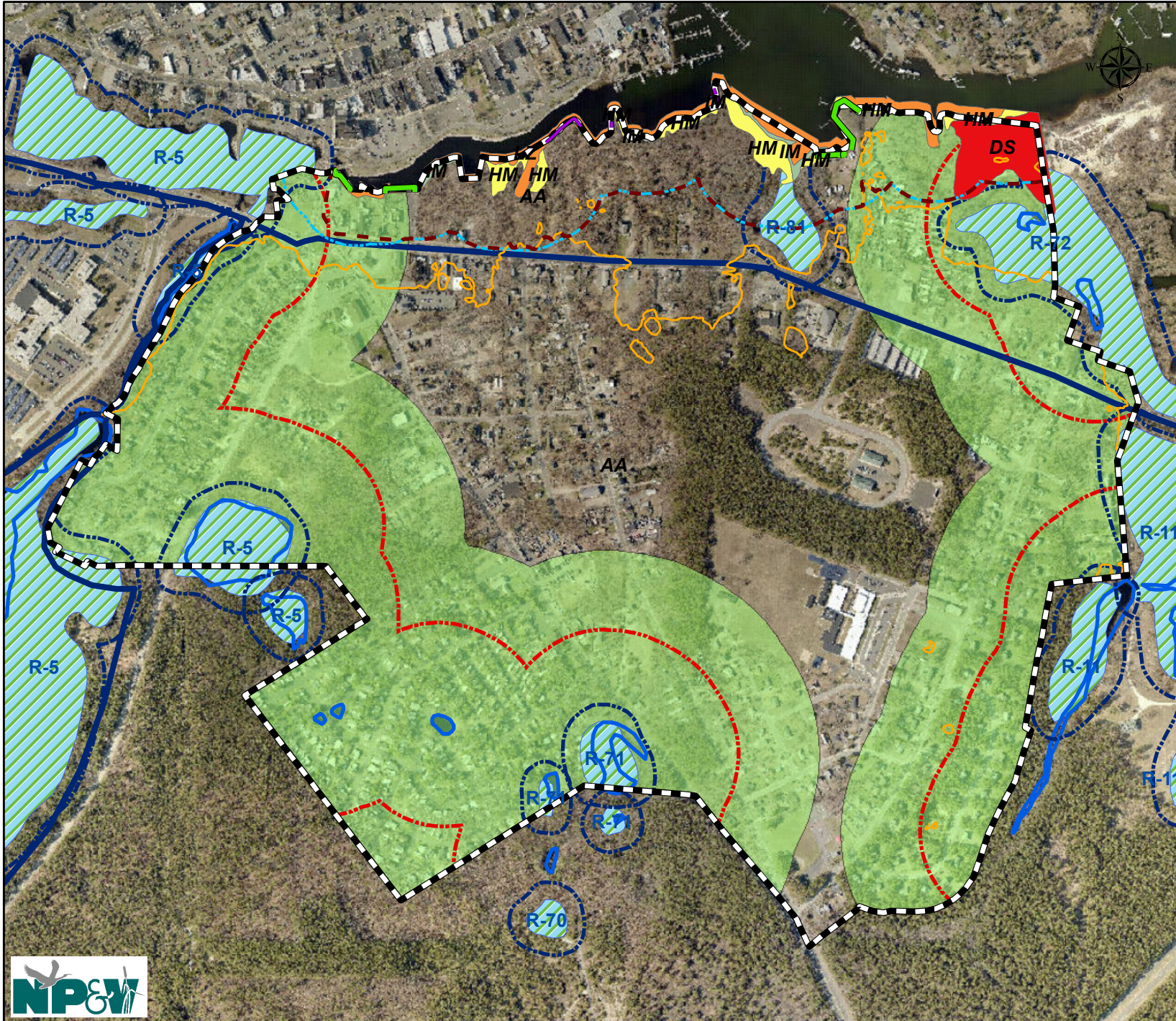

Town of Southampton
and
New York Department of State



Riverside BOA Revitalization
Action Plan and
Zoning Amendments

APPENDIX H
Natural Resource
Regulatory Jurisdictional
Areas (Approximate)

Legend

- Existing Bulkhead
- Condition
 - Failed
 - Functional
- Study Area
- Approximate Limit of
 - NYSDEC Tidal Wetland Jurisdiction
 - EL. 10
 - 300' Tidal Wetlands Buffer
 - NYS Coastal Boundary
- NYSDEC Tidal Wetlands
 - DS - Dredge Spoil
 - HM - High Marsh
 - IM - Intertidal Marsh
 - LZ - Littoral Zone
- Approximate NYSDEC 100'
 - Freshwater Wetlands Adjacent Area
 - Potential Tiger Salamander Breeding Ponds
 - NYSDEC Freshwater Wetlands
 - 535' Tiger Salamander Pond Habitat Preservation Setback
 - Approximate Tiger Salamander Upland Habitat Radius (1,000')

Source: Town of Southampton
Orthoimagery, 2014; NYSDEC;
Suffolk County LiDAR, 2006

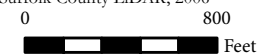

1 inch = 800 feet



**Final Generic Environmental Impact Statement
Riverside BOA, Revitalization Action Plan and
Zoning Amendments**

Parcels that May Require Further Tiger Salamander Habitat Investigation			
Tax ID Number	Area (Acres)	Street Address	Hamlet
900 - 118 - 2 - 1	0.7	129 Peconic Ave	Riverside
900 - 118 - 2 - 2	0.7	89 Peconic Ave	Riverside
900 - 118 - 2 - 29	0.2	120 Peconic Ave	Riverside
900 - 118 - 2 - 3.1	0.2	110 Peconic Ave	Riverside
900 - 118 - 2 - 4	0.4	7 Peconic Ave	Riverside
900 - 118 - 2 - 5	0.3	10 Flanders Rd	Riverside
900 - 118 - 2 - 6	0.4	14 Flanders Rd	Riverside
900 - 118 - 2 - 7	0.5	26 Flanders Rd	Riverside
900 - 118 - 2 - 8	1.2	30 Flanders Rd	Riverside
900 - 118.1 - 1 - 11	0.1	Row	Riverside
900 - 118.1 - 1 - 12.1	0.1	312A Flanders Rd	Riverside
900 - 118.1 - 1 - 13	0.3	316 Flanders Rd	Riverside
900 - 118.1 - 1 - 14	6.7	320 Flanders Rd	Riverside
900 - 118.1 - 1 - 15.1	0.1	Landlocked	Riverside
900 - 118.1 - 1 - 16	4.4	346 Flanders Rd	Riverside
900 - 118.1 - 1 - 17	0.9	21 Donald Ave	Riverside
900 - 118.1 - 1 - 20.1	0.1	40 Donald Ave	Riverside
900 - 118.1 - 1 - 21	0.2	16 Donald Ave	Riverside
900 - 118.1 - 1 - 22	0.5	372 Flanders Rd	Riverside
900 - 118.1 - 1 - 23	0.1	374 Flanders Rd	Riverside
900 - 118.1 - 1 - 24	0.2	378 Flanders Rd	Riverside
900 - 118.1 - 1 - 25	0.2	23 Kirk Ave	Riverside
900 - 118.1 - 1 - 26	0.1	29 Kirk Ave	Riverside
900 - 118.1 - 1 - 27	0.2	4 Kirk Ave	Riverside
900 - 118.1 - 1 - 28	0.1	8 Kirk Ave	Riverside
900 - 118.1 - 1 - 29	0.1	10 Kirk Ave	Riverside
900 - 118.1 - 1 - 30.1	0	Kirk Ave	Riverside
900 - 118.1 - 1 - 31.1	15.4	Landlocked	Riverside
900 - 118.1 - 1 - 32	5.9	500 Flanders Rd	Riverside
900 - 118.1 - 1 - 5	0.4	310 Flanders Rd	Riverside
900 - 118.1 - 1 - 6	0.5	308 Flanders Rd	Riverside
900 - 118.1 - 1 - 7	0.4	312B Flanders Rd	Riverside
900 - 118.1 - 1 - 8	2.3	306 Flanders Rd	Riverside
900 - 118.1 - 1 - 9	0	312C Flanders Rd	Riverside
900 - 119 - 1 - 18	0.3	404 Flanders Rd	Riverside
900 - 119 - 1 - 19	0.3	406 Flanders Rd	Riverside
900 - 119 - 1 - 20	2.9	408 Flanders Rd	Riverside
900 - 119 - 1 - 21	0.5	418 Flanders Rd	Riverside
900 - 119 - 1 - 22	0.1	420 Flanders Rd	Riverside
900 - 119 - 1 - 23	0.3	424 Flanders Rd	Riverside
900 - 119 - 1 - 24	0.2	440 Flanders Rd	Riverside
900 - 119 - 1 - 25	0.3	448 Flanders Rd	Riverside
900 - 119 - 1 - 26.1	34.4	500 Flanders Rd	Riverside
900 - 137 - 1 - 14.2	177.1	Cranberry Bog Park	Northampton
900 - 137 - 1 - 32	1.4	County Rd 94	Riverside
900 - 137 - 3 - 1	30	525 Riverleigh Ave	Riverside
900 - 138 - 1 - 10	0.1	61 Pegs Ln	Riverside

**Final Generic Environmental Impact Statement
Riverside BOA, Revitalization Action Plan and
Zoning Amendments**

Parcels that May Require Further Tiger Salamander Habitat Investigation			
Tax ID Number	Area (Acres)	Street Address	Hamlet
900 - 138 - 1 - 100	0.2	42 Woodhull Ave	Riverside
900 - 138 - 1 - 101	0.1	32 Woodhull Ave	Riverside
900 - 138 - 1 - 102	0	32 Woodhull Ave	Riverside
900 - 138 - 1 - 104.1	0.3	9 Lake Ave	Riverside
900 - 138 - 1 - 105	0.3	15 Lake Ave	Riverside
900 - 138 - 1 - 106	0.2	37 Lake Ave	Riverside
900 - 138 - 1 - 107	0.2	43 Lake Ave	Riverside
900 - 138 - 1 - 108	0.2	53 Lake Ave	Riverside
900 - 138 - 1 - 12.1	0.3	9 Pegs Ln	Riverside
900 - 138 - 1 - 13	0.2	5 Pegs Ln	Riverside
900 - 138 - 1 - 16	0.3	10 Pegs Ln	Riverside
900 - 138 - 1 - 18	0.2	12 Pegs Ln	Riverside
900 - 138 - 1 - 20.1	0.1	20 Pegs Ln	Riverside
900 - 138 - 1 - 21	0.4	24 Pegs Ln	Riverside
900 - 138 - 1 - 22	0.1	32 Pegs Ln	Riverside
900 - 138 - 1 - 23	0.1	195 Lake Ave	Riverside
900 - 138 - 1 - 24	0.1	175 Lake Ave	Riverside
900 - 138 - 1 - 26.1	0.3	155 Lake Ave	Riverside
900 - 138 - 1 - 28	0.1	187 Woodhull Ave	Riverside
900 - 138 - 1 - 29	0.2	185 Woodhull Ave	Riverside
900 - 138 - 1 - 3.3	0.3	87 Pegs Ln	Riverside
900 - 138 - 1 - 30	0.3	183 Woodhull Ave	Riverside
900 - 138 - 1 - 31	0.4	181 Woodhull Ave	Riverside
900 - 138 - 1 - 32	0.5	179 Woodhull Ave	Riverside
900 - 138 - 1 - 33	0.2	177 Woodhull Ave	Riverside
900 - 138 - 1 - 34	0.3	173 Woodhull Ave	Riverside
900 - 138 - 1 - 35	0.3	171 Woodhull Ave	Riverside
900 - 138 - 1 - 36	0.2	169 Woodhull Ave	Riverside
900 - 138 - 1 - 37	0.3	167 Woodhull Ave	Riverside
900 - 138 - 1 - 38	0.2	165 Woodhull Ave	Riverside
900 - 138 - 1 - 39.1	0.2	163 Woodhull Ave	Riverside
900 - 138 - 1 - 39.2	0.2	161 Woodhull Ave	Riverside
900 - 138 - 1 - 4	0.4	77 Pegs Ln	Riverside
900 - 138 - 1 - 40	0.2	159 Woodhull Ave	Riverside
900 - 138 - 1 - 41	0.3	157 Woodhull Ave	Riverside
900 - 138 - 1 - 42	0.3	155 Woodhull Ave	Riverside
900 - 138 - 1 - 43	0.4	77 Woodhull Ave	Riverside
900 - 138 - 1 - 44	0.6	49 Woodhull Ave	Riverside
900 - 138 - 1 - 46.11	0.8	57 Woodhull Ave	Riverside
900 - 138 - 1 - 46.2	0.3	43 Woodhull Ave	Riverside
900 - 138 - 1 - 5	0.2	75 Pegs Ln	Riverside
900 - 138 - 1 - 54	0.2	58 Woodhull Ave	Riverside
900 - 138 - 1 - 55	0.2	64 Woodhull Ave	Riverside
900 - 138 - 1 - 56	0.3	72 Woodhull Ave	Riverside
900 - 138 - 1 - 57	0.2	80 Woodhull Ave	Riverside
900 - 138 - 1 - 58	0.2	92 Woodhull Ave	Riverside
900 - 138 - 1 - 59	0.2	100 Woodhull Ave	Riverside

**Final Generic Environmental Impact Statement
Riverside BOA, Revitalization Action Plan and
Zoning Amendments**

Parcels that May Require Further Tiger Salamander Habitat Investigation			
Tax ID Number	Area (Acres)	Street Address	Hamlet
900 - 138 - 1 - 6	0.2	71 Pegs Ln	Riverside
900 - 138 - 1 - 60	0.2	108 Woodhull Ave	Riverside
900 - 138 - 1 - 61	0.2	116 Woodhull Ave	Riverside
900 - 138 - 1 - 62	0.4	124 Woodhull Ave	Riverside
900 - 138 - 1 - 63	0.6	132 Woodhull Ave	Riverside
900 - 138 - 1 - 64	0.2	136 Woodhull Ave	Riverside
900 - 138 - 1 - 65	0.2	140 Woodhull Ave	Riverside
900 - 138 - 1 - 66	0.2	142 Woodhull Ave	Riverside
900 - 138 - 1 - 67	0.2	148 Woodhull Ave	Riverside
900 - 138 - 1 - 68	0.2	180 Woodhull Ave	Riverside
900 - 138 - 1 - 69	0.2	184 Woodhull Ave	Riverside
900 - 138 - 1 - 7	0.4	67 Pegs Ln	Riverside
900 - 138 - 1 - 70	0.2	186 Woodhull Ave	Riverside
900 - 138 - 1 - 71	0.1	188 Woodhull Ave	Riverside
900 - 138 - 1 - 72	0.1	149 Lake Ave	Riverside
900 - 138 - 1 - 73	0.3	127 Lake Ave	Riverside
900 - 138 - 1 - 74	0.1	147 Lake Ave	Riverside
900 - 138 - 1 - 75	0.3	143 Lake Ave	Riverside
900 - 138 - 1 - 76	0.3	135 Lake Ave	Riverside
900 - 138 - 1 - 77	0.2	125 Lake Ave	Riverside
900 - 138 - 1 - 78	0.2	123 Lake Ave	Riverside
900 - 138 - 1 - 79	0.2	121 Lake Ave	Riverside
900 - 138 - 1 - 8	0.6	65 Pegs Ln	Riverside
900 - 138 - 1 - 80	0.2	119 Lake Ave	Riverside
900 - 138 - 1 - 81	0.2	97 Lake Ave	Riverside
900 - 138 - 1 - 82	0.2	83 Lake Ave	Riverside
900 - 138 - 1 - 83	0.3	79 Lake Ave	Riverside
900 - 138 - 1 - 84	0.3	69 Lake Ave	Riverside
900 - 138 - 1 - 85	0.2	63 Lake Ave	Riverside
900 - 138 - 1 - 86	0.2	57 Lake Ave	Riverside
900 - 138 - 1 - 9	0.1	63 Pegs Ln	Riverside
900 - 138 - 1 - 91.1	0.4	6 Pegs Ln	Riverside
900 - 138 - 1 - 92	0.3	175 Woodhull Ave	Riverside
900 - 138 - 1 - 93.1	0.3	1 Pegs Ln	Riverside
900 - 138 - 1 - 94.1	0.5	91 Pegs Ln	Riverside
900 - 138 - 1 - 96.1	0.1	189 Woodhull Ave	Riverside
900 - 138 - 1 - 97	0	Cranberry Bog Park	Riverside
900 - 138 - 1 - 98	0.3	33 Woodhull Ave	Riverside
900 - 138 - 1 - 99	0.2	50 Woodhull Ave	Riverside
900 - 138 - 2 - 10	0.4	47 Maynard St	Riverside
900 - 138 - 2 - 11	0.2	41 Maynard St	Riverside
900 - 138 - 2 - 12	0.3	37 Maynard St	Riverside
900 - 138 - 2 - 13	0.1	31 Maynard St	Riverside
900 - 138 - 2 - 14	0.1	25 Maynard St	Riverside
900 - 138 - 2 - 15	0.1	17 Maynard St	Riverside
900 - 138 - 2 - 16	0.3	11 Maynard St	Riverside
900 - 138 - 2 - 19	0.4	16 Maynard St	Riverside

**Final Generic Environmental Impact Statement
Riverside BOA, Revitalization Action Plan and
Zoning Amendments**

Parcels that May Require Further Tiger Salamander Habitat Investigation			
Tax ID Number	Area (Acres)	Street Address	Hamlet
900 - 138 - 2 - 20	0.1	30 Maynard St	Riverside
900 - 138 - 2 - 21	0.1	36 Maynard St	Riverside
900 - 138 - 2 - 22	0.3	44 Maynard St	Riverside
900 - 138 - 2 - 29.1	5.8	30 Lake Ave	Riverside
900 - 138 - 2 - 30	0.9	20 Riverleigh Ave	Riverside
900 - 138 - 2 - 31	0	9 Flanders Rd	Riverside
900 - 138 - 2 - 32	0.8	11 Flanders Rd	Riverside
900 - 138 - 2 - 33	0.3	39 Flanders Rd	Riverside
900 - 138 - 2 - 8.1	1.6	269 Riverleigh Ave	Riverside
900 - 138 - 2 - 8.2	0.7	273 Riverleigh Ave	Riverside
900 - 138 - 2 - 8.3	0.6	325 Riverleigh Ave	Riverside
900 - 138 - 2 - 9	0.6	393 Riverleigh Ave	Riverside
900 - 139 - 1 - 62.1	0.3	242 Riverleigh Ave	Riverside
900 - 139 - 1 - 66	0.3	226 Riverleigh Ave	Riverside
900 - 139 - 1 - 74.1	1.6	234 Riverleigh Ave	Riverside
900 - 139 - 2 - 48	0.1	117 Old Quogue Rd	Riverside
900 - 139 - 2 - 49.1	2.9	113 Old Quogue Rd	Riverside
900 - 139 - 2 - 50.2	2.5	500 Riverleigh Ave	Riverside
900 - 139 - 2 - 70.1	4.1	429 Riverleigh Ave	Riverside
900 - 139 - 2 - 73	0.3	437 Riverleigh Ave	Riverside
900 - 139 - 2 - 74.1	1.7	515 Riverleigh Ave	Riverside
900 - 139 - 2 - 75	10	411 Riverleigh Ave	Riverside
900 - 139 - 2 - 76	1.1	421 Riverleigh Ave	Riverside
900 - 139 - 2 - 77	0.3	423 Riverleigh Ave	Riverside
900 - 139 - 2 - 78	0.4	423 Riverleigh Ave #a	Riverside
900 - 139 - 2 - 79.1	0.1	425 Riverleigh Ave	Riverside
900 - 139 - 2 - 82.1	0.8	Riverleigh Ave	Riverside
900 - 139 - 2 - 83	0.1	Riverleigh Ave	Riverside
900 - 139 - 2 - 84	0.1	Riverleigh Ave	Riverside
900 - 139 - 3 - 10.2	12.4	243 Flanders Rd	Riverside
900 - 139 - 3 - 38	0.2	116 Old Quogue Rd	Riverside
900 - 139 - 3 - 39	0.2	118 Old Quogue Rd	Riverside
900 - 139 - 3 - 40	0.1	120 Old Quogue Rd	Riverside
900 - 139 - 3 - 41	0.1	124 Old Quogue Rd	Riverside
900 - 139 - 3 - 42	0.1	134 Old Quogue Rd	Riverside
900 - 140 - 1 - 1	27	525 Riverleigh Ave	Riverside
900 - 140 - 1 - 10	0.3	568 Riverleigh Ave	Riverside
900 - 140 - 1 - 12	0.2	600 Riverleigh Ave	Riverside
900 - 140 - 1 - 13	0.1	606 Riverleigh Ave	Riverside
900 - 140 - 1 - 14	2.4	131 Old Quogue Rd	Riverside
900 - 140 - 1 - 15	2.5	185 Old Quogue Rd	Riverside
900 - 140 - 1 - 2	0.3	532 Riverleigh Ave	Riverside
900 - 140 - 1 - 3	0.2	534 Riverleigh Ave	Riverside
900 - 140 - 1 - 4	0.2	538 Riverleigh Ave	Riverside
900 - 140 - 1 - 5	0.1	542 Riverleigh Ave	Riverside
900 - 140 - 1 - 6	0.4	544 Riverleigh Ave	Riverside
900 - 140 - 1 - 7	0.1	546 Riverleigh Ave	Riverside

**Final Generic Environmental Impact Statement
Riverside BOA, Revitalization Action Plan and
Zoning Amendments**

Parcels that May Require Further Tiger Salamander Habitat Investigation			
Tax ID Number	Area (Acres)	Street Address	Hamlet
900 - 140 - 1 - 8	2	249 Old Quogue Rd	Riverside
900 - 140 - 1 - 9	0.1	564 Riverleigh Ave	Riverside
900 - 140 - 2 - 10	0.2	10 Brown St	Riverside
900 - 140 - 2 - 11	0.2	20 Brown St	Riverside
900 - 140 - 2 - 12	0.2	17 Goodridge Ave	Riverside
900 - 140 - 2 - 13	0.2	21 Goodridge Ave	Riverside
900 - 140 - 2 - 14	0.2	27 Goodridge Ave	Riverside
900 - 140 - 2 - 15	0.2	31 Goodridge Ave	Riverside
900 - 140 - 2 - 16	0.2	35 Goodridge Ave	Riverside
900 - 140 - 2 - 17.1	0.2	43 Goodridge Ave	Riverside
900 - 140 - 2 - 18	0.3	51 Goodridge Ave	Riverside
900 - 140 - 2 - 19	0.3	57 Goodridge Ave	Riverside
900 - 140 - 2 - 2	0.1	186 Old Quogue Rd	Riverside
900 - 140 - 2 - 20	0.2	65 Goodridge Ave	Riverside
900 - 140 - 2 - 21	0.5	73 Goodridge Ave	Riverside
900 - 140 - 2 - 22	0.7	28 Randall St	Riverside
900 - 140 - 2 - 23	0.4	52 Goodridge Ave	Riverside
900 - 140 - 2 - 24	0.6	44 Goodridge Ave	Riverside
900 - 140 - 2 - 25	0.4	34 Goodridge Ave	Riverside
900 - 140 - 2 - 26	0.2	16 Randall St	Riverside
900 - 140 - 2 - 31	0.3	19 Randall St	Riverside
900 - 140 - 2 - 32	0	11 Randall St	Riverside
900 - 140 - 2 - 33	0.2	7 Randall St	Riverside
900 - 140 - 2 - 34	0.2	20 Goodridge Ave	Riverside
900 - 140 - 2 - 35	0.4	6 Goodridge Ave	Riverside
900 - 140 - 2 - 36	0.4	42 Brown St	Riverside
900 - 140 - 2 - 39	0.2	190 Phillips Ave	Riverside
900 - 140 - 2 - 40	0.2	68 Brown St	Riverside
900 - 140 - 2 - 41	0.1	180 Phillips Ave	Riverside
900 - 140 - 2 - 42	0.2	170 Phillips Ave	Riverside
900 - 140 - 2 - 43	0.3	164 Phillips Ave	Riverside
900 - 140 - 2 - 44	0.3	165 Ludlam Ave	Riverside
900 - 140 - 2 - 45	0.3	173 Ludlam Ave	Riverside
900 - 140 - 2 - 46	0.2	179 Ludlam Ave	Riverside
900 - 140 - 2 - 47	0.3	185 Ludlam Ave	Riverside
900 - 140 - 2 - 48	0.2	195 Ludlam Ave	Riverside
900 - 140 - 2 - 49	0.2	203 Ludlam Ave	Riverside
900 - 140 - 2 - 5.1	0.6	194 Old Quogue Rd	Riverside
900 - 140 - 2 - 50	0.2	207 Ludlam Ave	Riverside
900 - 140 - 2 - 51	0.2	211 Ludlam Ave	Riverside
900 - 140 - 2 - 52	0.2	215 Ludlam Ave	Riverside
900 - 140 - 2 - 53	0.2	219 Ludlam Ave	Riverside
900 - 140 - 2 - 54	0.2	223 Ludlam Ave	Riverside
900 - 140 - 2 - 57.1	4.5	239 Ludlam Ave	Riverside
900 - 140 - 2 - 58	0.5	57 Brown St	Riverside
900 - 140 - 2 - 59	0.2	47 Brown St	Riverside
900 - 140 - 2 - 6	0.4	206 Old Quogue Rd	Riverside

**Final Generic Environmental Impact Statement
Riverside BOA, Revitalization Action Plan and
Zoning Amendments**

Parcels that May Require Further Tiger Salamander Habitat Investigation			
Tax ID Number	Area (Acres)	Street Address	Hamlet
900 - 140 - 2 - 61	0.2	39 Brown St	Riverside
900 - 140 - 2 - 62	0.2	33 Brown St	Riverside
900 - 140 - 2 - 63	0.2	25 Brown St	Riverside
900 - 140 - 2 - 64	0.2	17 Brown St	Riverside
900 - 140 - 2 - 65	0.2	11 Brown St	Riverside
900 - 140 - 2 - 66	0.1	240 Old Quogue Rd	Riverside
900 - 140 - 2 - 67	0.1	244 Old Quogue Rd	Riverside
900 - 140 - 2 - 68	0.1	248 Old Quogue Rd	Riverside
900 - 140 - 2 - 69	0.3	156 Phillips Ave	Riverside
900 - 140 - 2 - 7	0.3	218 Old Quogue Rd	Riverside
900 - 140 - 2 - 70	0.3	157 Ludlam Ave	Riverside
900 - 140 - 2 - 71.1	0.6	182 Old Quogue Rd	Riverside
900 - 140 - 2 - 72	0	Goodridge Ave	Riverside
900 - 140 - 2 - 73	1.5	77 Goodridge Ave	Riverside
900 - 140 - 2 - 8	0.2	224 Old Quogue Rd	Riverside
900 - 140 - 2 - 9	0.2	230 Old Quogue Rd	Riverside
900 - 141 - 1 - 11.1	14.8	141 Phillips Ave	Riverside
900 - 141 - 1 - 17.4	3.3	345 Flanders Rd	Riverside
900 - 141 - 1 - 18.1	0.7	373 Flanders Rd	Riverside
900 - 141 - 1 - 5.2	1.7	369 Flanders Rd	Riverside
900 - 141 - 1 - 8.2	0.9	Private Road	Riverside
900 - 141 - 1 - 9.6	1.9	28 Enterprise Zone Dr	Riverside
900 - 141 - 1 - 9.7	1.4	26 Enterprise Zone Dr	Riverside
900 - 141 - 2 - 10	0.3	78 Ludlam Ave	Riverside
900 - 141 - 2 - 11	0.2	70 Ludlam Ave	Riverside
900 - 141 - 2 - 12	0.6	62 Ludlam Ave	Riverside
900 - 141 - 2 - 13	0.6	52 Ludlam Ave	Riverside
900 - 141 - 2 - 14	0.6	50 Ludlam Ave	Riverside
900 - 141 - 2 - 15.1	0.5	30 Ludlam Ave	Riverside
900 - 141 - 2 - 15.2	0.5	36 Ludlam Ave	Riverside
900 - 141 - 2 - 16	0.3	24 Ludlam Ave	Riverside
900 - 141 - 2 - 17	0.3	18 Ludlam Ave	Riverside
900 - 141 - 2 - 18.2	0.5	15 Ludlam Ave	Riverside
900 - 141 - 2 - 19	0.3	25 Ludlam Ave	Riverside
900 - 141 - 2 - 2	0.5	301 Flanders Rd	Riverside
900 - 141 - 2 - 20	0.2	33 Ludlam Ave	Riverside
900 - 141 - 2 - 21.2	0.5	28 Phillips Ave	Riverside
900 - 141 - 2 - 22.5	1.3	37 Ludlam Ave	Riverside
900 - 141 - 2 - 23	1	61 Ludlam Ave	Riverside
900 - 141 - 2 - 24	0.8	54 Phillips Ave	Riverside
900 - 141 - 2 - 25	0.2	65 Ludlam Ave	Riverside
900 - 141 - 2 - 26	0.2	71 Ludlam Ave	Riverside
900 - 141 - 2 - 27	0.2	75 Ludlam Ave	Riverside
900 - 141 - 2 - 28	0.2	77 Ludlam Ave	Riverside
900 - 141 - 2 - 29	0.7	91 Ludlam Ave	Riverside
900 - 141 - 2 - 3	0.6	415 Flanders Rd	Riverside
900 - 141 - 2 - 30	0.3	99 Ludlam Ave	Riverside

**Final Generic Environmental Impact Statement
Riverside BOA, Revitalization Action Plan and
Zoning Amendments**

Parcels that May Require Further Tiger Salamander Habitat Investigation			
Tax ID Number	Area (Acres)	Street Address	Hamlet
900 - 141 - 2 - 31	0.3	102 Phillips Ave	Riverside
900 - 141 - 2 - 32	0.3	110 Phillips Ave	Riverside
900 - 141 - 2 - 33	0.3	33 Van Houton St	Riverside
900 - 141 - 2 - 34	0.3	107 Ludlam Ave	Riverside
900 - 141 - 2 - 36.1	1	140 Phillips Ave	Riverside
900 - 141 - 2 - 36.3	1.4	117 Ludlam Ave	Riverside
900 - 141 - 2 - 37	0.3	148 Phillips Ave	Riverside
900 - 141 - 2 - 38	0.4	149 Ludlam Ave	Riverside
900 - 141 - 2 - 39.1	0.9	61 Whitebrook Dr	Riverside
900 - 141 - 2 - 39.2	0.9	67 Whitebrook Dr	Riverside
900 - 141 - 2 - 4	1	437 Flanders Rd	Riverside
900 - 141 - 2 - 40	0.5	389 Flanders Rd	Riverside
900 - 141 - 2 - 5	0.3	443 Flanders Rd	Riverside
900 - 141 - 2 - 6	0.6	33 Whitebrook Dr	Riverside
900 - 141 - 2 - 7	0.7	39 Whitebrook Dr	Riverside
900 - 141 - 2 - 8	0.7	47 Whitebrook Dr	Riverside
900 - 141 - 2 - 9	0.8	55 Whitebrook Dr	Riverside
900 - 142 - 1 - 1.1	0.6	2 Pebble Way	Riverside
900 - 142 - 1 - 1.10	0.5	20 Pebble Way	Riverside
900 - 142 - 1 - 1.11	0.4	22 Pebble Way	Riverside
900 - 142 - 1 - 1.12	0.5	24 Pebble Way	Riverside
900 - 142 - 1 - 1.13	0.5	26 Pebble Way	Riverside
900 - 142 - 1 - 1.14	0.8	28 Pebble Way	Riverside
900 - 142 - 1 - 1.15	0.6	30 Pebble Way	Riverside
900 - 142 - 1 - 1.16	0.5	32 Pebble Way	Riverside
900 - 142 - 1 - 1.17	0.4	112 Ludlam Ave	Riverside
900 - 142 - 1 - 1.18	0.8	110 Ludlam Ave	Riverside
900 - 142 - 1 - 1.19	0.7	108 Ludlam Ave	Riverside
900 - 142 - 1 - 1.2	0.6	4 Pebble Way	Riverside
900 - 142 - 1 - 1.20	0.4	106 Ludlam Ave	Riverside
900 - 142 - 1 - 1.21	0.5	104 Ludlam Ave	Riverside
900 - 142 - 1 - 1.22	0.7	102 Ludlam Ave	Riverside
900 - 142 - 1 - 1.23	0.6	100 Ludlam Ave	Riverside
900 - 142 - 1 - 1.24	0.5	98 Ludlam Ave	Riverside
900 - 142 - 1 - 1.25	0.5	96 Ludlam Ave	Riverside
900 - 142 - 1 - 1.26	0.5	94 Ludlam Ave	Riverside
900 - 142 - 1 - 1.27	0.9	86 Ludlam Ave	Riverside
900 - 142 - 1 - 1.28	0.8	15 Pebble Way	Riverside
900 - 142 - 1 - 1.29	0.8	13 Pebble Way	Riverside
900 - 142 - 1 - 1.3	0.5	6 Pebble Way	Riverside
900 - 142 - 1 - 1.30	0.5	11 Pebble Way	Riverside
900 - 142 - 1 - 1.31	0.5	9 Pebble Way	Riverside
900 - 142 - 1 - 1.32	0.4	7 Pebble Way	Riverside
900 - 142 - 1 - 1.33	0.6	5 Pebble Way	Riverside
900 - 142 - 1 - 1.34	0.5	3 Pebble Way	Riverside
900 - 142 - 1 - 1.35	0.5	1 Pebble Way	Riverside
900 - 142 - 1 - 1.36	0.6	228 Ludlam Ave	Riverside

**Final Generic Environmental Impact Statement
Riverside BOA, Revitalization Action Plan and
Zoning Amendments**

Parcels that May Require Further Tiger Salamander Habitat Investigation			
Tax ID Number	Area (Acres)	Street Address	Hamlet
900 - 142 - 1 - 1.37	0.5	196 Ludlam Ave	Riverside
900 - 142 - 1 - 1.38	0.5	184 Ludlam Ave	Riverside
900 - 142 - 1 - 1.39	0.4	170 Ludlam Ave	Riverside
900 - 142 - 1 - 1.4	0.5	8 Pebble Way	Riverside
900 - 142 - 1 - 1.40	0.7	162 Ludlam Ave	Riverside
900 - 142 - 1 - 1.41	1	Recharge Area	Riverside
900 - 142 - 1 - 1.42	29.5	Wild Conservation Land	Riverside
900 - 142 - 1 - 1.5	0.6	10 Pebble Way	Riverside
900 - 142 - 1 - 1.6	0.5	12 Pebble Way	Riverside
900 - 142 - 1 - 1.7	0.5	14 Pebble Way	Riverside
900 - 142 - 1 - 1.8	0.5	16 Pebble Way	Riverside
900 - 142 - 1 - 1.9	0.5	18 Pebble Way	Riverside
900 - 142 - 1 - 53	39.8	12 Whitebrook Dr	Riverside
900 - 142 - 1 - 54.2	1.1	27 Whitebrook Dr	Riverside
900 - 142 - 1 - 54.4	0.9	Whitebrook Drive	Riverside
900 - 194 - 1 - 1.3	1258.2	Wild Conservation Land	Northampton

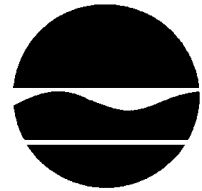

Guidance for Land Cover Set Asides for Conservation of the Eastern Tiger Salamander And Suggested Methods to Avoid, Minimize, and Mitigate Impacts

In the discharge of its authority and responsibility to protect and conserve endangered species under ECL Article 11-0535 and associated regulations 6 NYCRR § 182.6, and as a general matter, DEC urges developers to minimize adverse impacts to tiger salamanders by conforming with both of the following when designing projects that would occur on lands within 1,000 feet of known tiger salamander breeding ponds (measurements should be taken from average water level based on water marks, rack lines and vegetation):

- a) Preserving 100% of the existing upland forest habitat within 535 feet of the breeding pond.
- b) Preserving a minimum of 50% of the adjacent upland area within 1,000 feet of breeding ponds in contiguous blocks of suitable habitat, while allowing for the preservation of wooded corridors which provide connections to adjacent tiger salamander upland habitats. The exact configuration of this habitat is subject to the particular site history and habitat features of a project site.

In general, the habitat closest to the wetland is given a higher priority, with a secondary priority being the preservation of intact corridors of habitat that will allow animals to move off of the subject parcel to other suitable habitat if they choose to do so. Where possible, development is encouraged within existing disturbed areas. The preferred habitat of the salamanders is mature oak-pine woodlands. In general, the preserved area should contain as much oak pine woodland as possible, with development occurring on existing footprints of previous buildings, parking areas, roadways or tilled fields. Therefore, the optimal layout for any particular site can vary depending on site specific features such as historic land use, habitat coverage, and adjacent land cover. In addition, preserved areas should remain undisturbed with no grading, excavation, clearing or similar physical activity allowed except as noted below. DEC may request that additional measures be undertaken to protect preserved upland areas including installation of fencing, signage, supplemental plantings of native woody species, and closure of existing pathways that currently provide access to such preserved areas.

Additional requirements:

Roadways: For all newly constructed roadways within 1,000 feet of known tiger ponds, at least one culvert suitable for the passage of migrating tiger salamanders must be placed under the roadway for every 100 feet of roadway within 1,000 feet of known breeding ponds. All curbing installed within 1000 feet must have a minimum height of 8" above grade on the side facing out from the roadbed to prevent tiger salamanders from inadvertently crossing the road and being killed. This curbing should also be sloped (1:3) on the side facing in from the roadbed to allow

salamanders the ability to exit the road back to their natural habitat. Another approved curb design is also called Cape Cod Curbing (see Figure 1). Curbing must also be placed around leaching pools, catch basins and similar storm water drainage structures to prevent inadvertent entry of tiger salamanders into these structures.

Pools: All pools within 1,000 feet of tiger salamander breeding ponds must be surrounded by a steeply-sided curb of no less than 8" above grade and which also extends well below the surface.

Other Created Bodies of Surface Water (e.g. recharge or decorative ponds, etc.): All other created (man-made) bodies of surface water within 1,000 feet of tiger salamander breeding ponds must be surrounded by a steeply-sided curb of no less than 4" above grade and which also extends well below the surface.

Window wells: All window wells must be constructed so that either the lip of the well is a minimum of 4" above grade or else a steeply-sided curb of no less than 4" above grade is constructed around the area enclosing the window well.

Lighting: New lighting shall be directed away from Tiger Salamander ponds and should be of a spectrum that does not interfere with the biological activity of this species.

Public Water Supply Wells and Other Groundwater Wells: New groundwater wells for potable water supply, irrigation, firefighting and other purposes should be placed at a distance sufficient from any tiger salamander breeding pond so as to ensure that operation of the well does not result in significant adverse drawdown of surface water levels in the pond.

Use of the preserved area for drainage: The breeding pond must not be utilized as a catch basin for drainage. However, water may be directed into the preserved area as long as the area receiving water does not drain into the breeding pond, the area of upland habitat will not be significantly impacted or altered (e.g. covered with rip-rap), the area of upland habitat receiving storm water is sufficiently small in size so as not to represent a significant percentage of upland tiger salamander habitat and significant quantities of sediment are not introduced into the area.

Mosquito Control and Pesticides: No application of larvicides containing Methoprene shall be made to tiger salamander breeding ponds. No predatory fish such as Gambusia or other finfish may be introduced into Tiger Salamander breeding ponds. Applications of other pesticides or implementation of other mosquito control techniques may require DEC approval.

Management of Preserved Upland Habitat Areas: Appropriate and adequate management plans will be developed and implemented for the management of upland tiger salamander habitat areas preserved as a result of this policy. Said management plans will identify the owner of the preserved area and procedures undertaken to protect and preserve the area. Such measures may include but shall not be limited to frequent patrols of the preserved area; closing of access points to motorized vehicles including cars, trucks, ATVs, motorbikes as well as horses and mountain bikes; restrictive covenants; maintenance and preservation of existing vegetation; planting of supplemental vegetation in denuded areas; fencing; etc.

Figure 1: Example of Cape Cod Curbing

